



WHEEL 125P2V2R1W



Product SKU	125P2V2R1W
Standard Compliance	DIN EN 12532
Series	P2V2
Material of the Wheel	polypropylene (PP) wheel center
Tread	thermoplastic rubber tread
Temperature range	-20°C to +60°C
Wheel Diameter	125mm
Load Capacity	135kg
Width of Tread	32mm
wheel hub Width	50mm
Wheel Bolt Size	M10
Bushing Diameter	15mm
Weight	0.36kg
Wheel Bearing	roller bearing
Rubber Shore	85° Shore A



WHEEL 125P2V2R1W

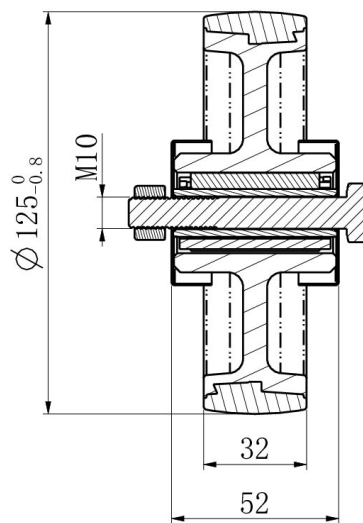
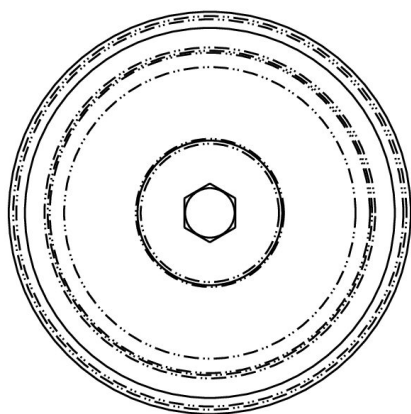

TD_125P2V2R1W		
load capacity	135KG	