



WHEEL 080SWU5D0N-70



Product SKU	080SWU5D0N-70
Material of the Wheel	steel wheel center
Tread	cast polyurethane (CPU) tread
Temperature range	-20°C to +60°C
Wheel Diameter	80mm
Load Capacity	500kg
Wheel Bearing	double ball bearing
Rubber Shore	95° Shore A





WHEEL 080SWU5D0N-70

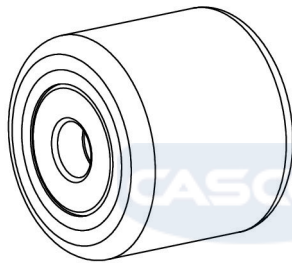
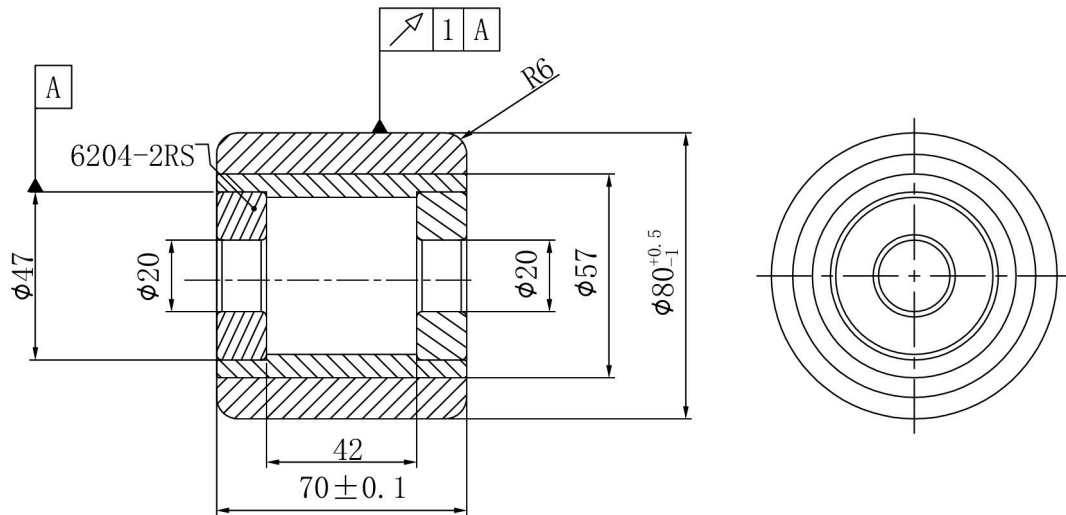

080SWU5D0N-70		
load capacity	500KG	