

RATTAKOMPLEKT SPP31WC125T6P2R1W



| | |
|----------------------------|----------------------------------|
| Toote SKU | SPP31WC125T6P2R1W |
| Standardivastavus | DIN EN 12532 |
| Seeria | T6P2 |
| Kinnitamine | Plaatkinnitusega |
| Pidur ja suund | pöörlev ilma pidurita |
| Ratta materjal | ratta keskosa polüpropüleen (PP) |
| Protektor | turvis polüpropüleen (PP) |
| Temperatuurivahemik | -20°C kuni +60°C |
| Ratta läbimõõt | 125mm |
| Kandevõime | 200kg |
| Kogukõrgus | 155mm |
| Protektori laius | 36mm |
| Ratta naba laius | 50mm |
| Nihe | 40mm |
| Plaadi mõõtmed | 105x80mm |
| Plaadi aukaugus | 80/77x60mm |
| Rattapoldi suurus | M10 |
| Puksi läbimõõt | 15mm |
| Kaal | 1kg |
| Rattalaager | nõellaager |



RATTAKOMPLEKT SPP31WC125T6P2R1W

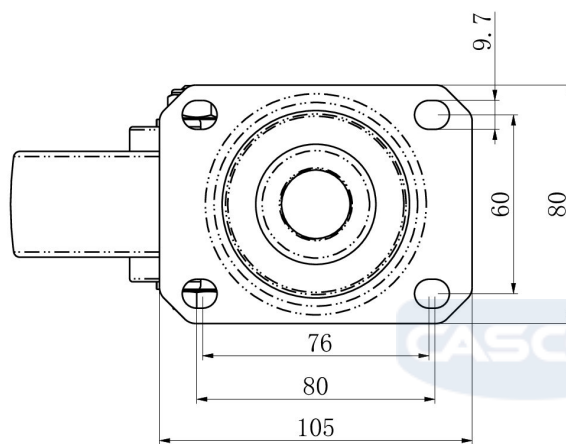
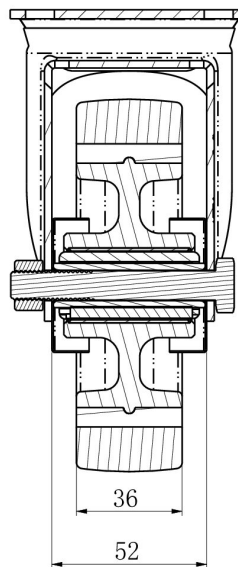
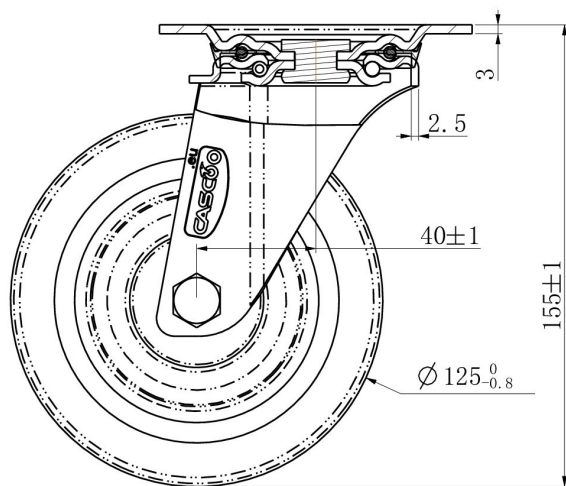

| | | |
|----------------------|-------|---|
| TD_SPP31WC125T6P2R1W | |  |
| load capacity | 200KG | |